

Hugo 2186x2000x520 mm

ASSEMBLY INSTRUCTION

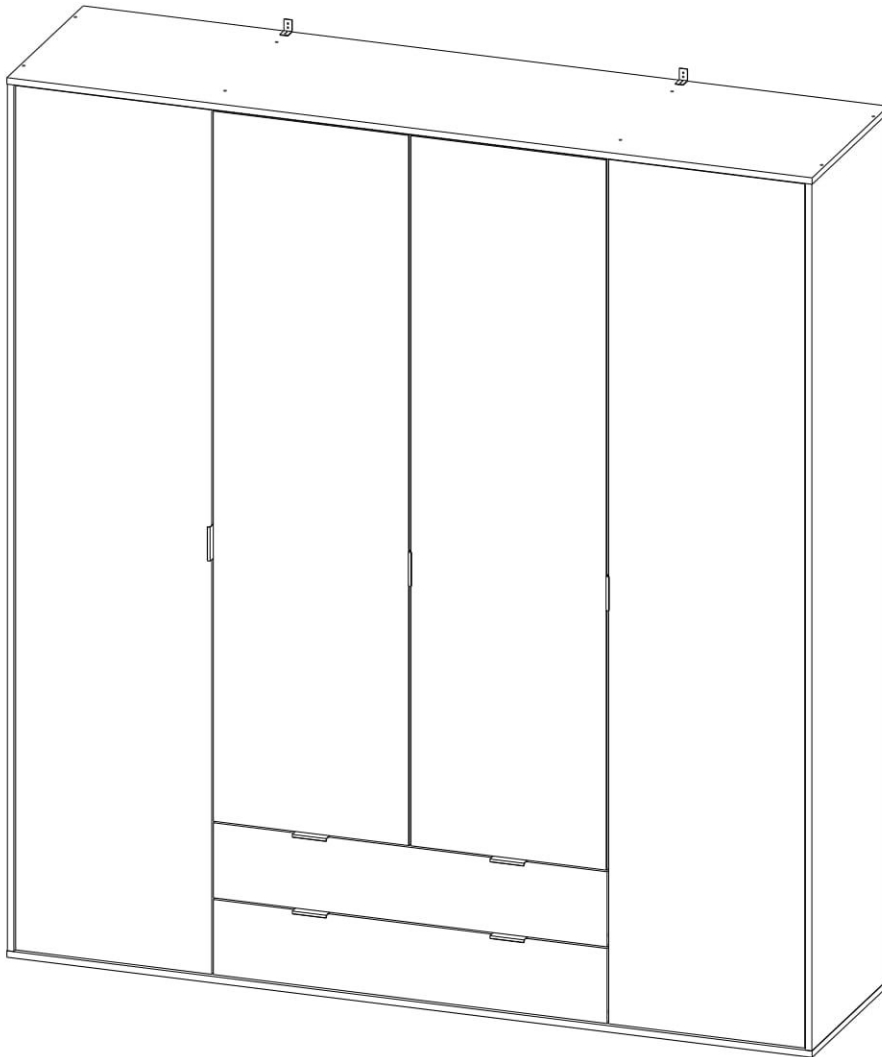

The dowel and the wall mounting angle are not included.
Purchase separately.



NOTE!

For all questions and complaints about this product, please contact the place of purchase of this product.



RULES FOR USE AND CARE OF FURNITURE

1. Use furniture only in dry rooms protected from the effects of weather conditions.
2. Install with suitable tools according to these assembly instructions.
3. Try to assemble as close to the location as possible.
4. The body is assembling in a horizontal position.
5. Before moving furniture, make sure that it is not loaded with items.

Caution: moving furniture may damage it.

When moving, hold on to vertical elements only; moving furniture by horizontal parts can break the product.

6. Overloading the furniture can damage it.
7. From time to time check the fittings and their correct position.
8. Wipe the furniture surface only with a slightly damp cloth or paper towels. Do not use chemical cleaning agents other than those specifically made for this.

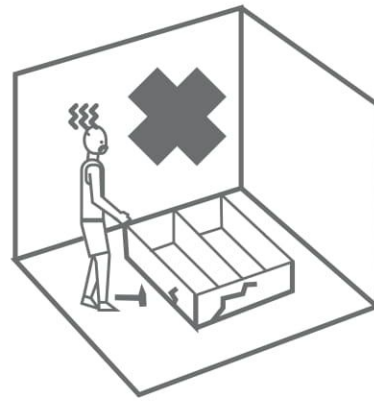
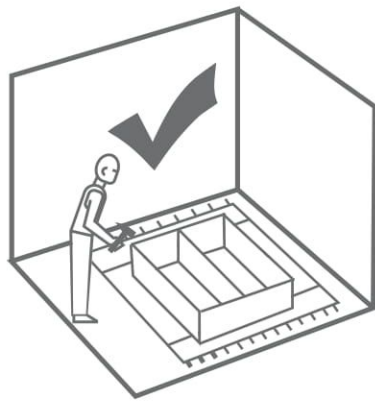
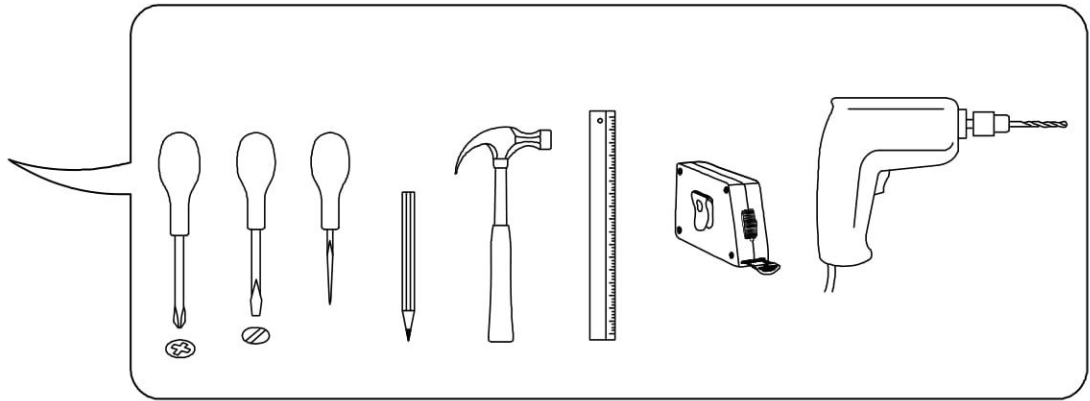

60-120 min

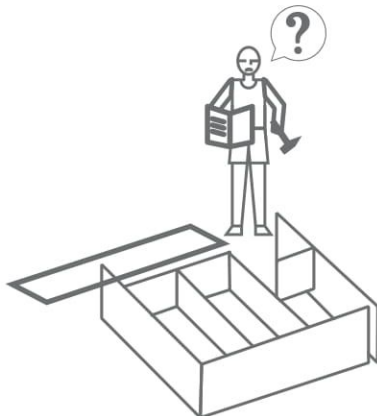
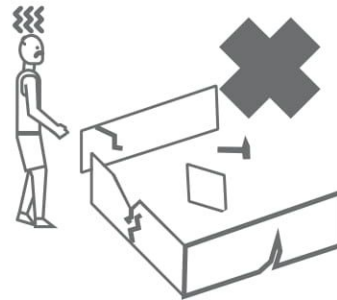
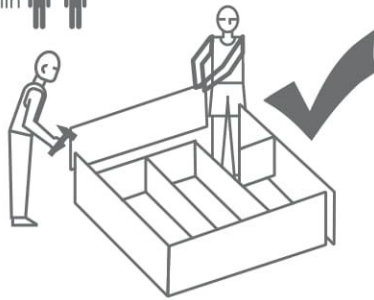

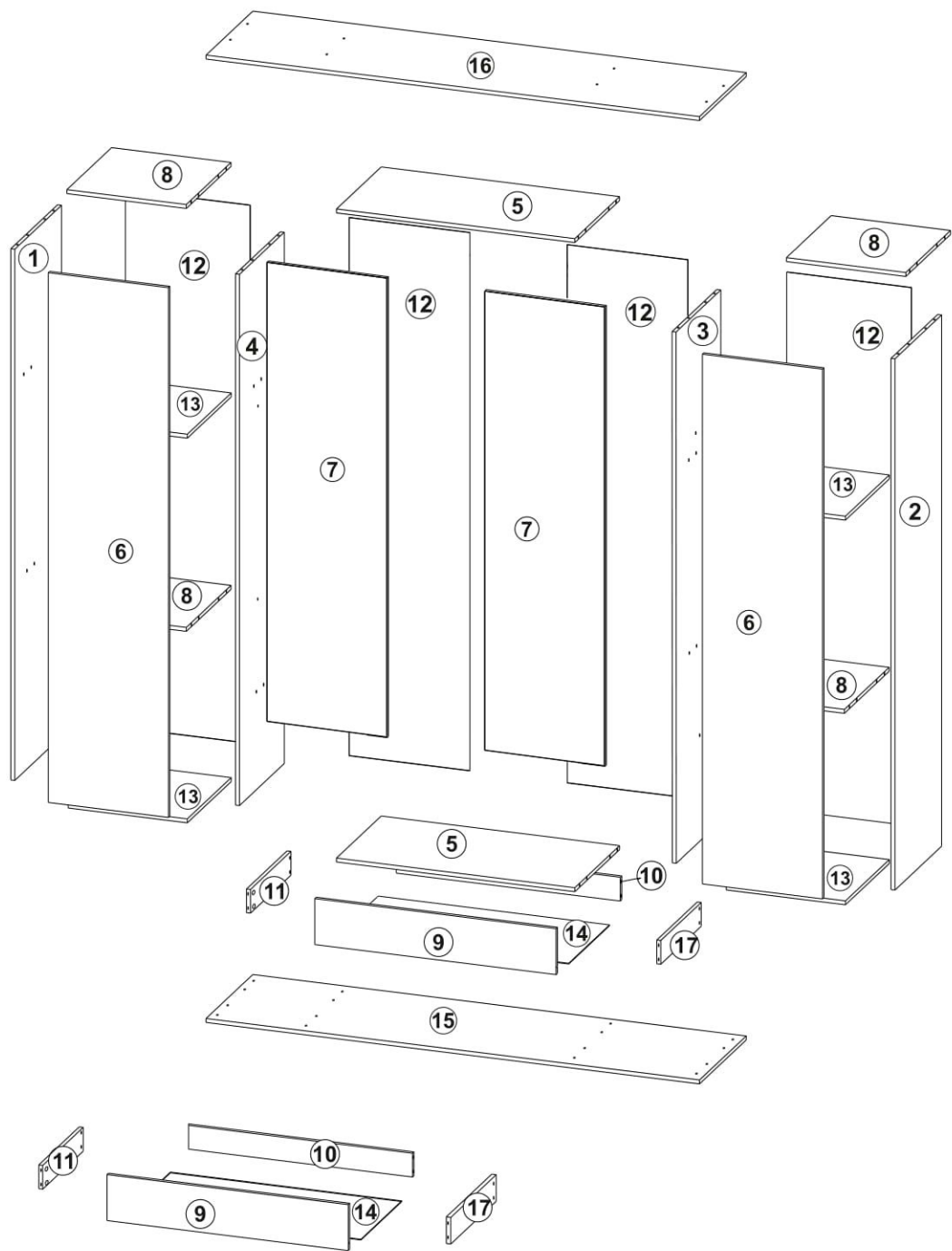

4x 15x10x14mm c14	8x D	6x E	16x 20/9 r16	16x φ15x12mm #16 r1	2x n906	1x z1
7x	40x φ7x50 mm e32	40x φ8x30 mm f1	50x φ6x13 mm e3	4x w5	4x w5	1x l1
1x	16x φ5x17 mm	s2	84x φ3,5x16 mm p38	8x dl1	1x wr	s3
14x	10x φ3,5x16 mm p39					

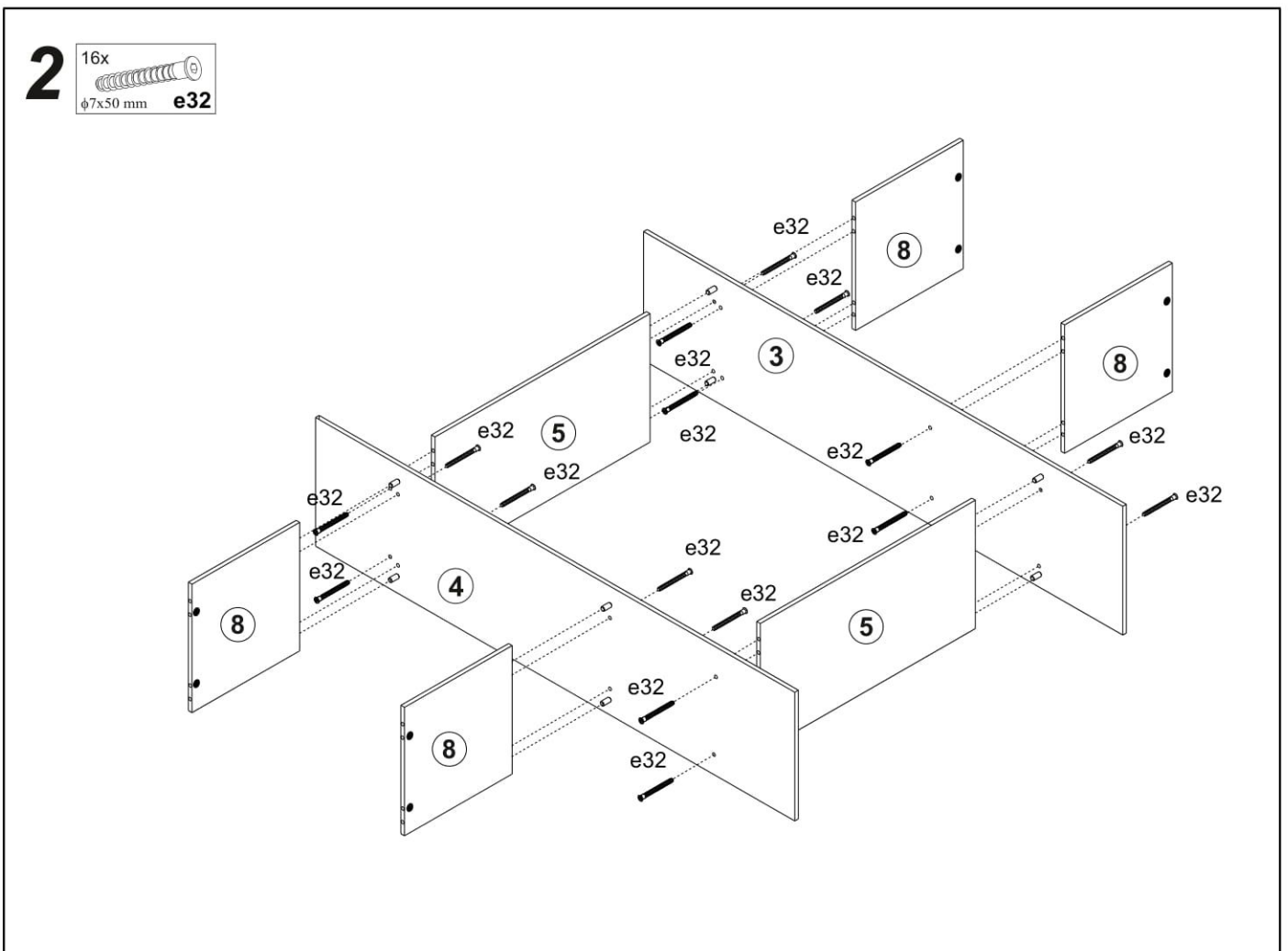
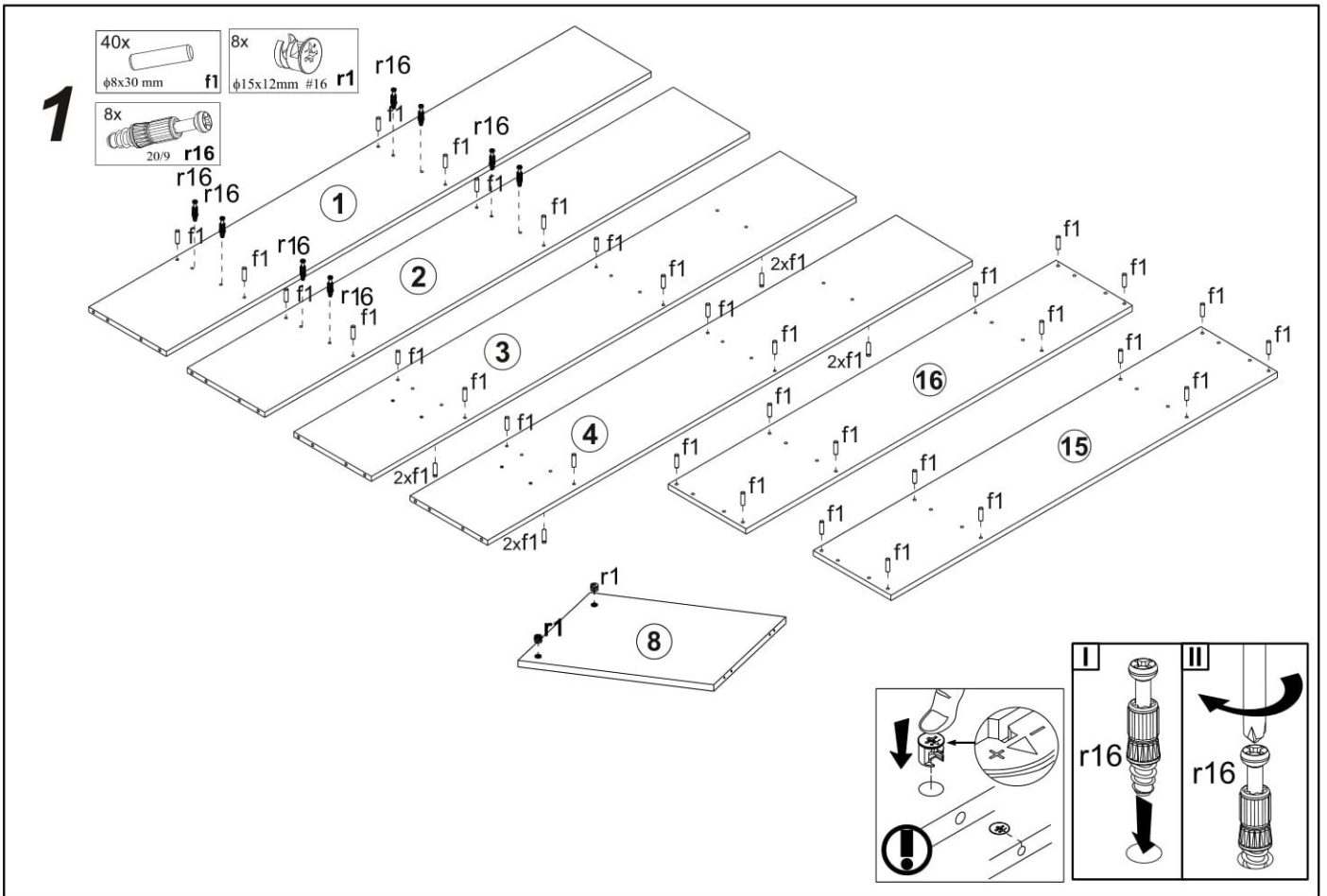

3

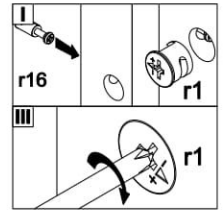
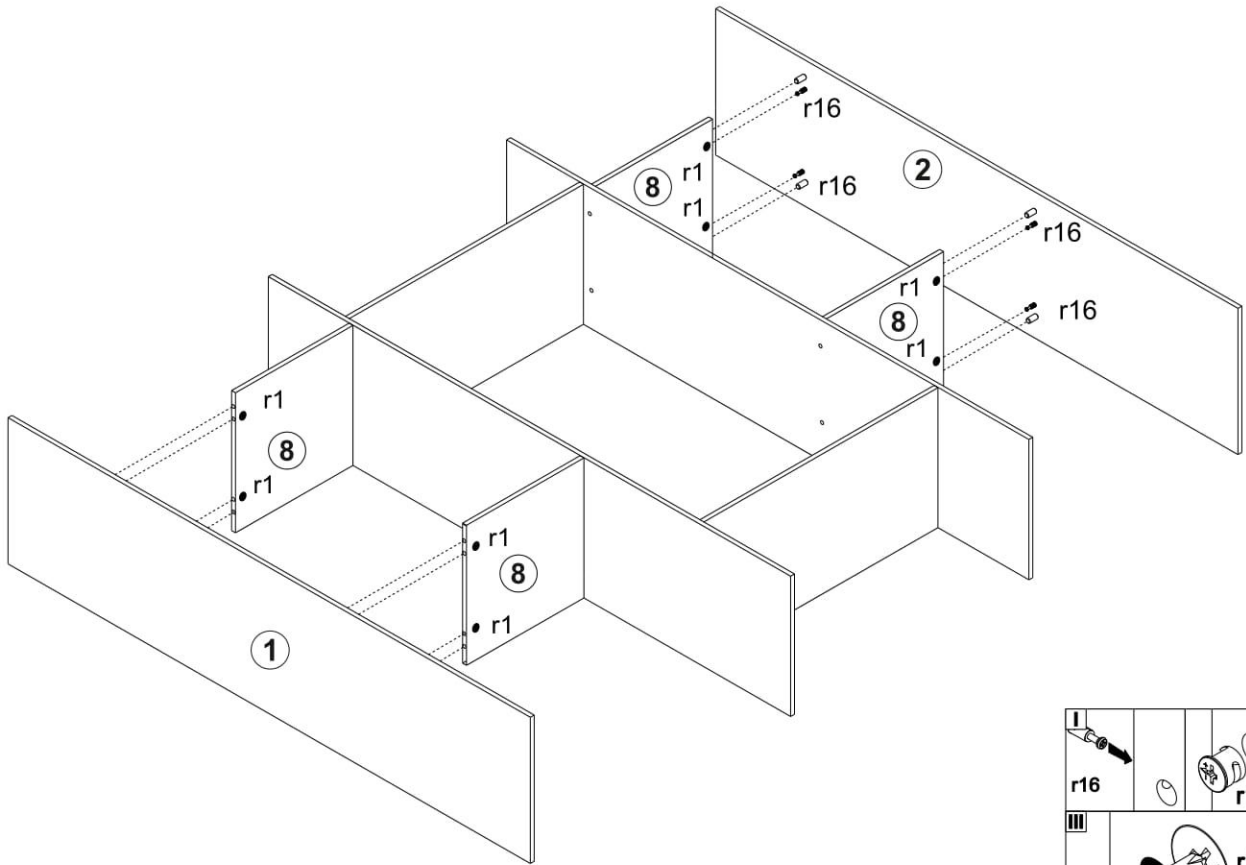

4

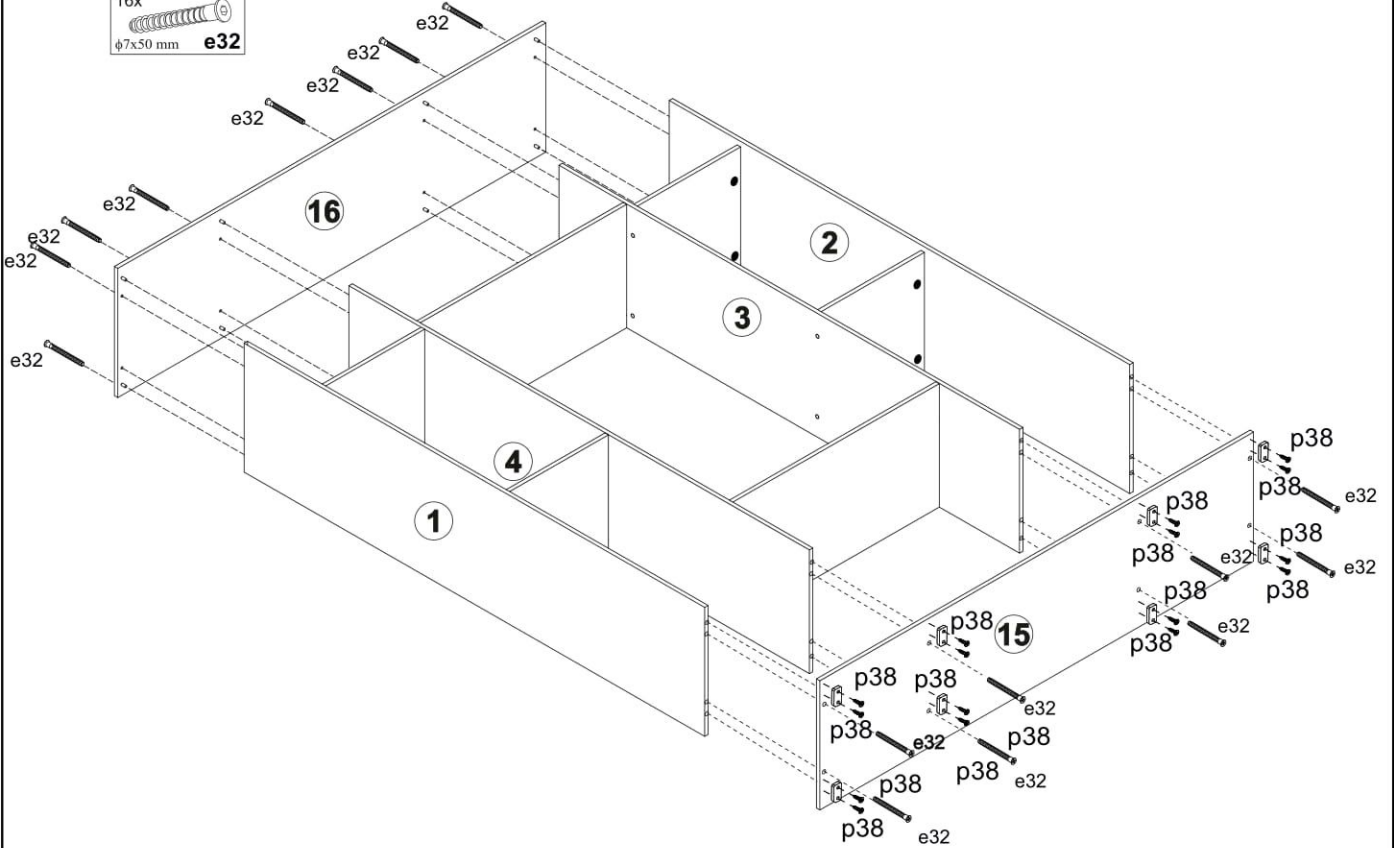
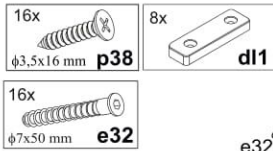

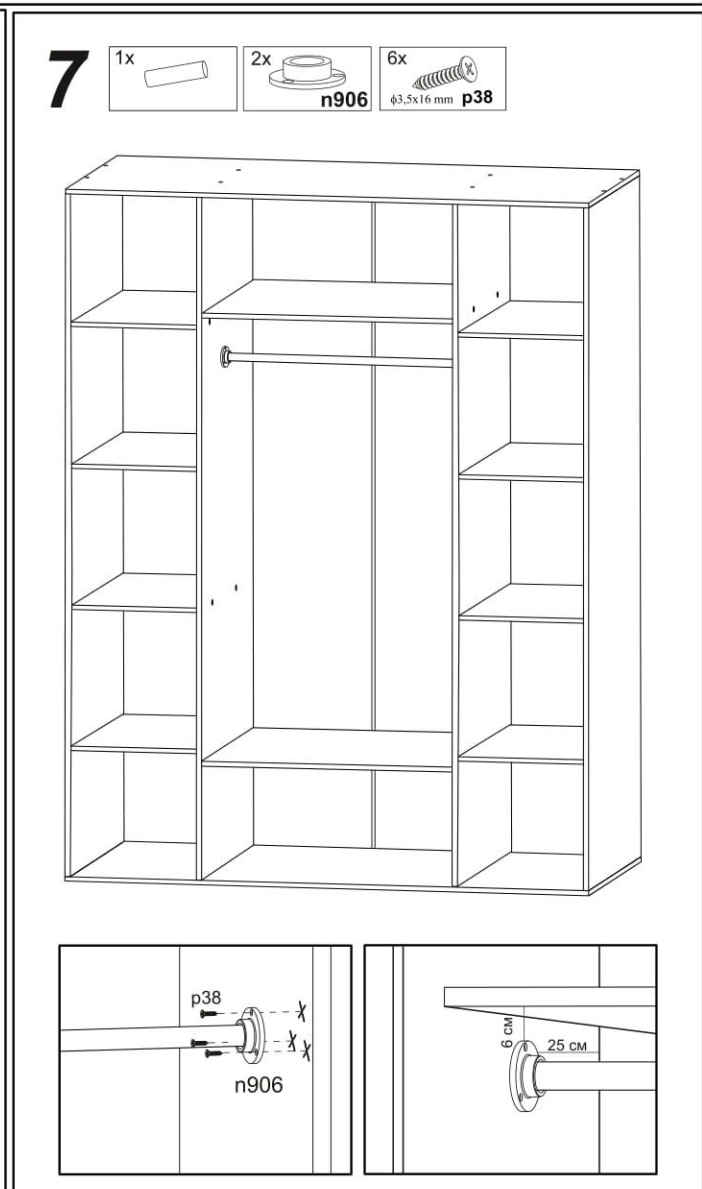
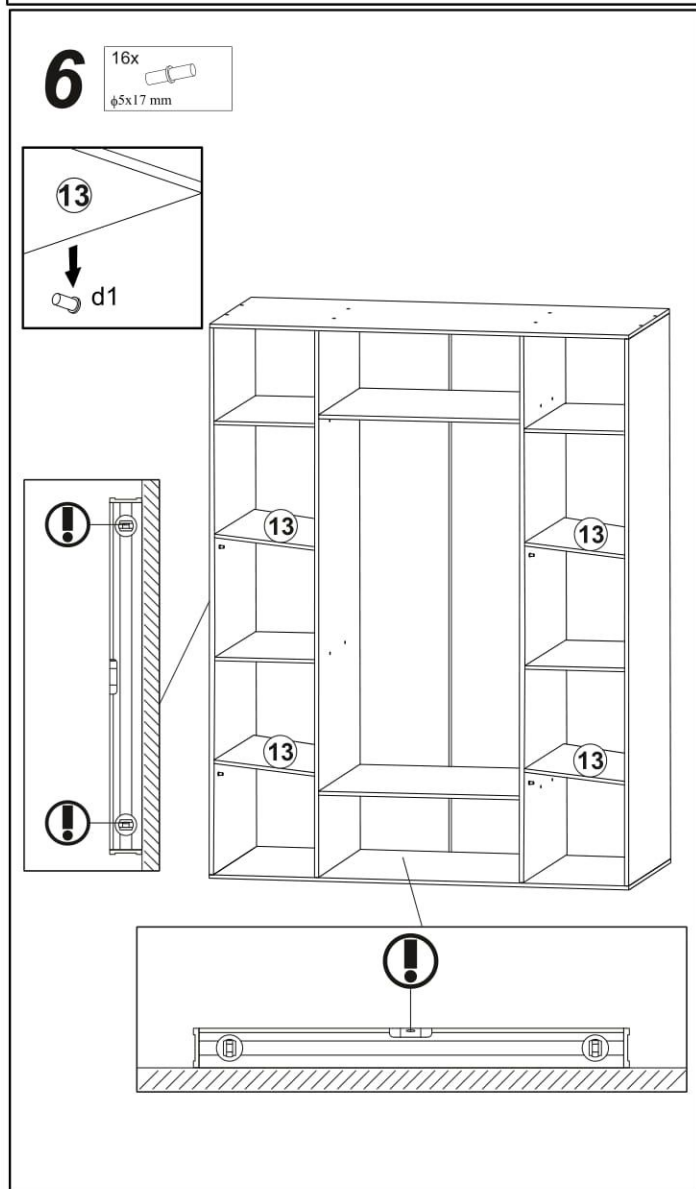
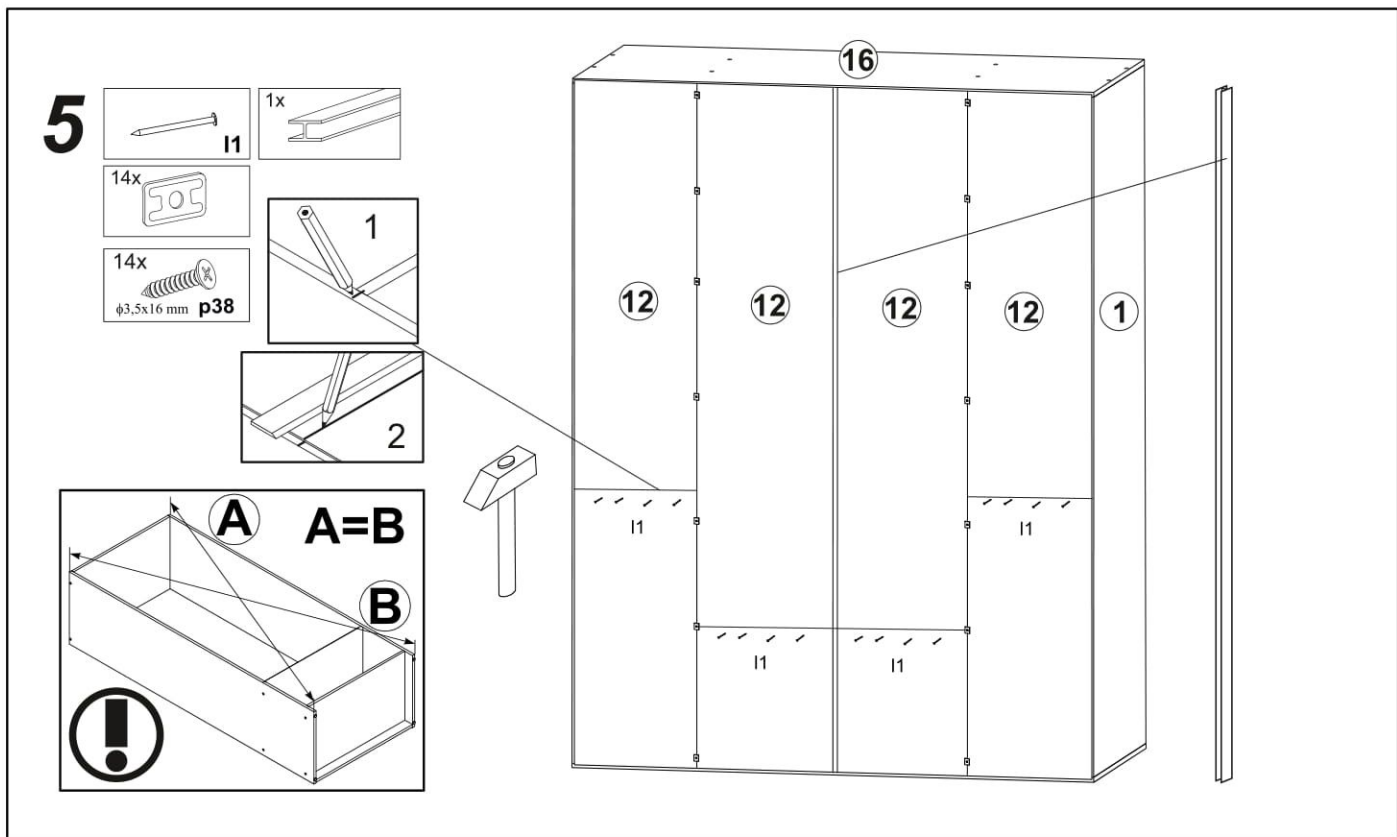

8

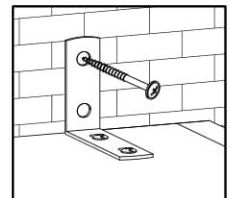
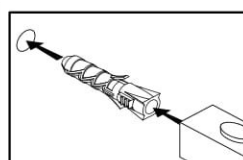
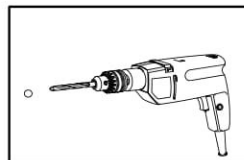
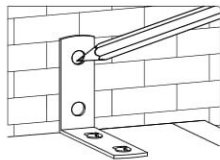
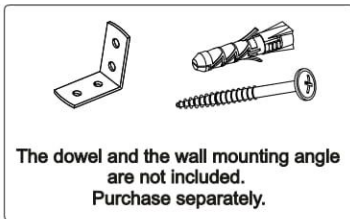
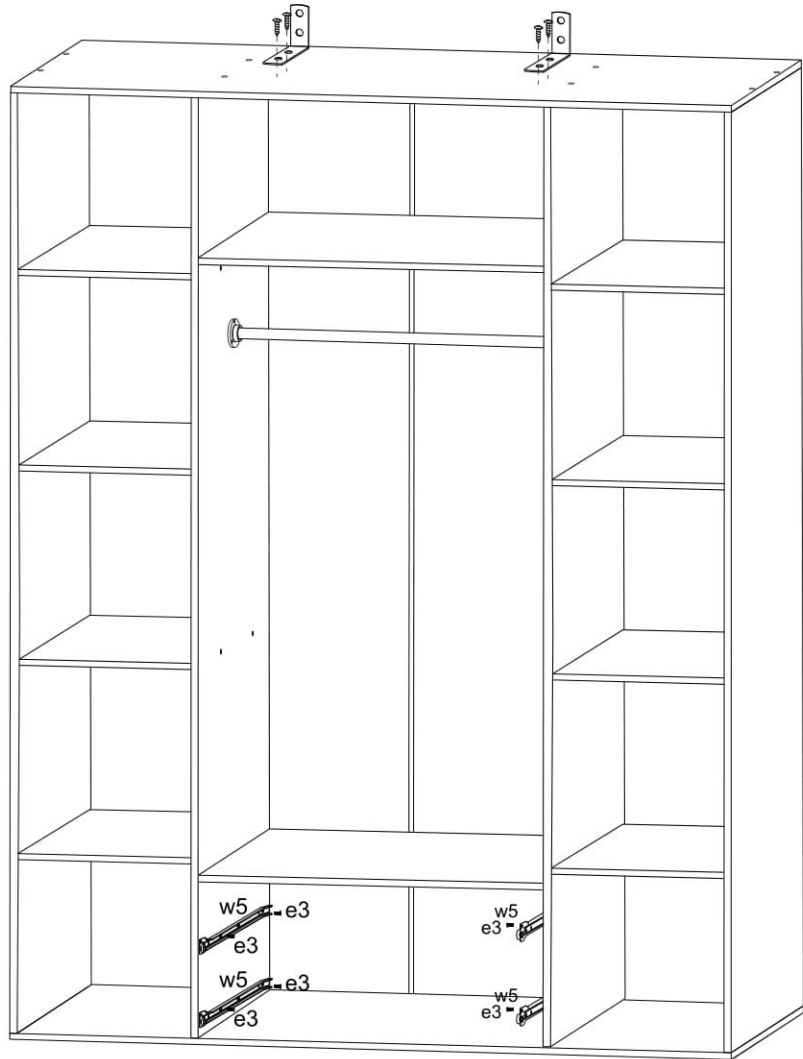
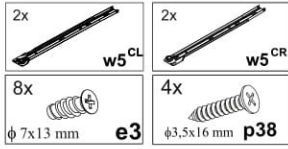

9

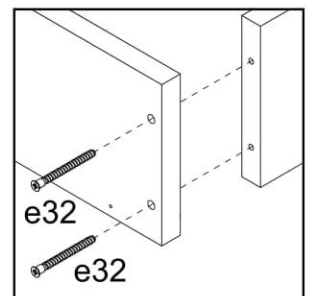
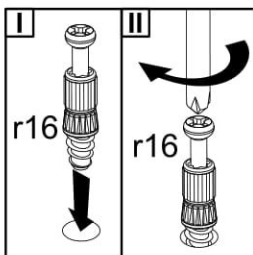
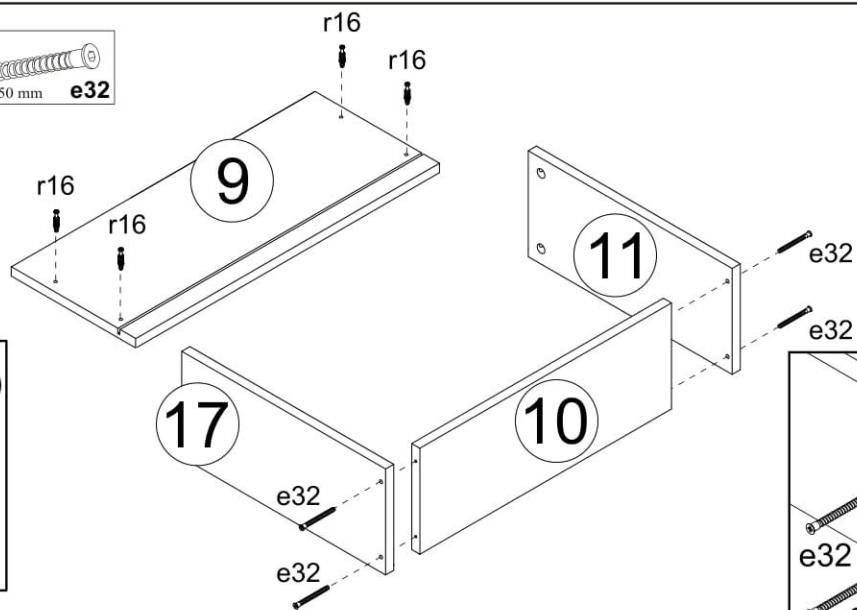

10

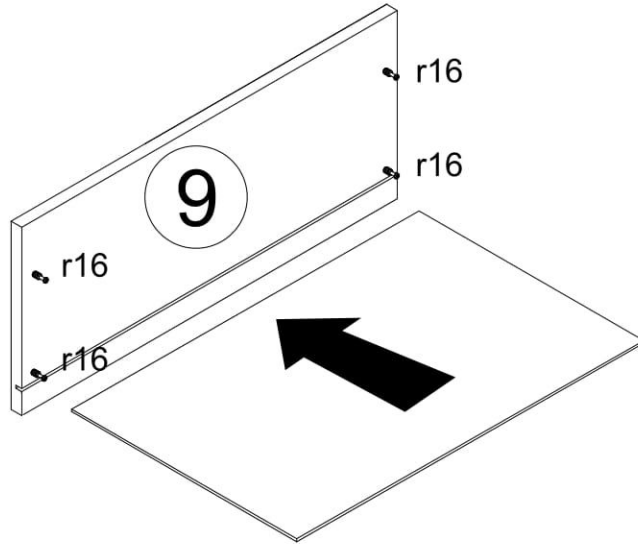

11

8x
 $\phi 15 \times 12 \text{ mm}$ #16 r1

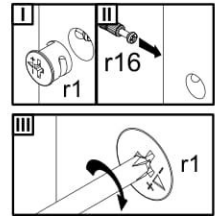
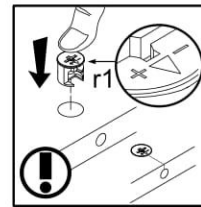
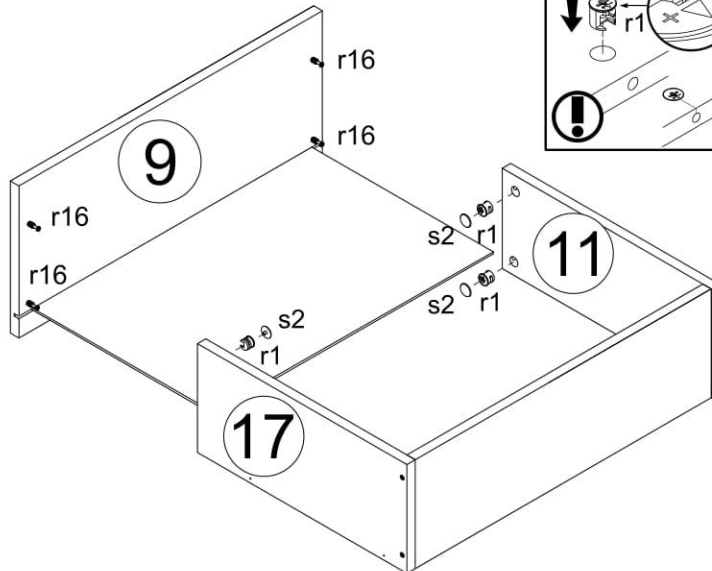

12

16x $\phi 3,5 \times 16 \text{ mm}$ p38
2x w5^{DL}
2x w5^{DR}
4x 15x10x14mm c14
10x $\phi 3,5 \times 16 \text{ mm}$ p39

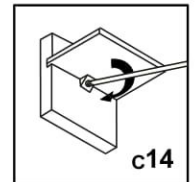
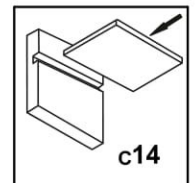
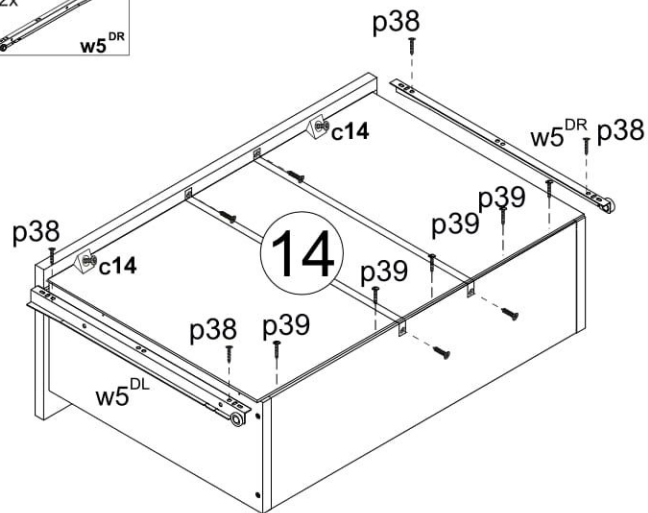

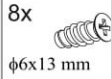

13

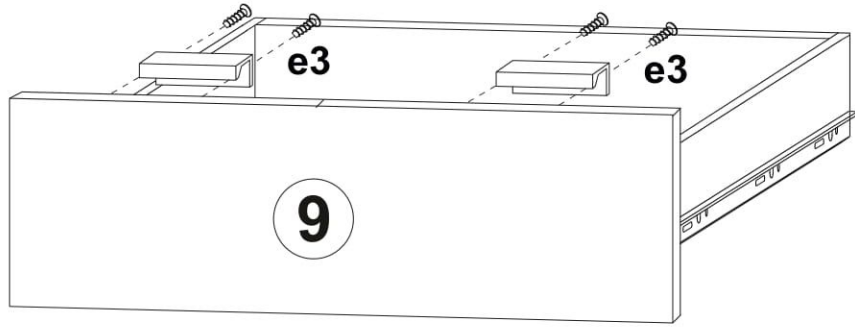
- 4x 
- 8x  $\phi 6 \times 13 \text{ mm}$ e3





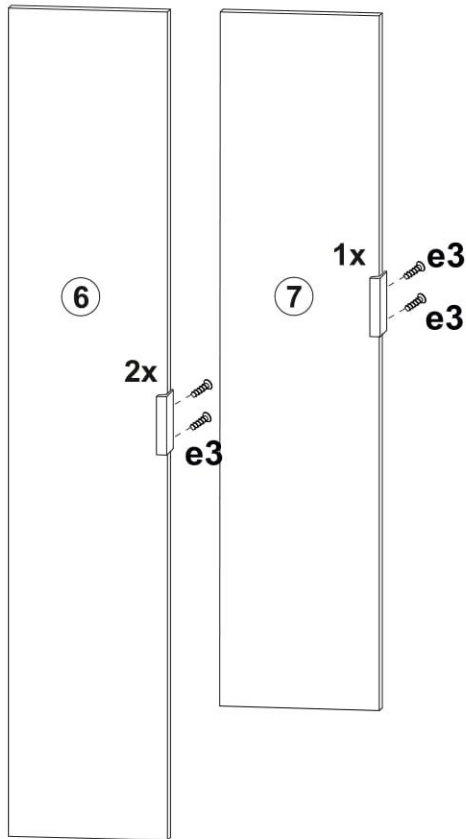

14

- 3x 
- 6x  $\phi 6 \times 13 \text{ mm}$ e3

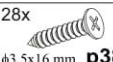

13

- 28x  $\phi 3,5 \times 16 \text{ mm}$ p38
- 28x  $\phi 6 \times 13 \text{ mm}$ e3
- 8x  D
- 6x  E

